

Application: Combination eye wash and safety shower. Shower is activated by pull rod and eye wash is activated by flag handle or foot treadle. Two sprayer outlet heads deliver a flood of water for rising eyes.

Shower Head: 10" diameter head provide water flow.

Shower Valve: 1" IPS stainless steel valve.

Spray Head Assembly: Two sprayers offer more wash and has a dust cover. Internal flow control and filter to remove impurities from the water flow.

Eye Wash Bowl: 11-1/2" diameter.
Bowl material is stainless steel 304.

Eye Wash Valve: 3/8" IPS stainless steel stay-open ball valve. Valve is activated by flag handle or foot treadle. Unit remains in operation until handle is returned to closed position.

Pipe and Fittings: Schedule 1-1/4" stainless steel pipe.

Water Supply: 1-1/4" BSP/NPT female inlet.

Water Waste: 1-1/4" BSP/NPT female outlet.

Assembling: Valve, bowl and spray head are factory pre-assembled.

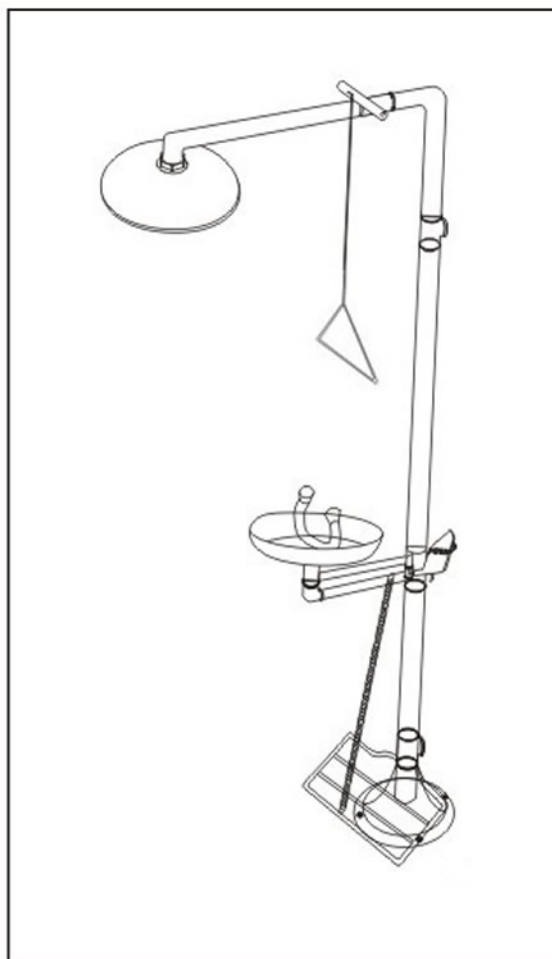

Product feature

1. Shower head can deliver 76 liters of water per minute.
Large area cover of water flow at 60", the water pattern cover 20" in diameter.
Center of the water pattern 16" from any obstructions.
2. Eye washer can deliver 11.5 liters of water per minute.
Dust cover can protect spray heads from airborne or other contaminants.
3. Ball valve activated within one second.
Valve actuator are easy to locate and readily assembled to user.
4. Hands-free open valve activate within one second.
5. Easily located accessible actuator no higher than 69".
Connect unit to uninterruptible water supply delivering at 3GPM.
6. Products are meet EN15154-1 & 2 (DIN 12899), ANSI Z358.1 and AS 4775 standard.

Product Details Parts Listing

	Part Name	Description	Pieces
A	Shower Head	Stainless Steel	1 piece
B	Shower Valve	Stainless Steel	1 piece
C	Pull Rod	Stainless Steel	1 piece
D	Shower Connecting Pipe	1" Stainless Steel	1 piece
E	Pipe Pack	1-1/4" Stainless Steel	3 pieces
F	Eye Washer Set	Central Sprayer	1 set
G	Basin Connecting Pipe Set	Stainless Steel	1 set
H	Hand Control Panel	Stainless Steel	1 piece
I	Foot Control Panel	Stainless Steel	1 piece
J	Connection Chain	Stainless Steel	1 piece
K	Floor Flange	Stainless Steel	1 piece

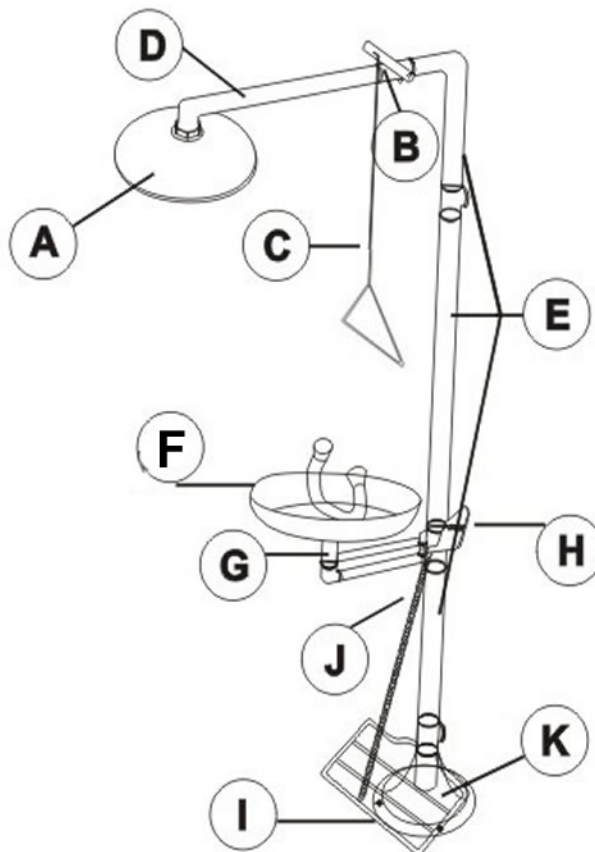

Product Part Details

Terysafe Safety Shower is designed for easy assembly in the field. Essentially, the units are assembled from the "bottom up" as described below:

1. Assembled PART 1 (BASE UNIT) to PART 2 (BASIN UNIT).
2. Assembled PART 3 (HOSE) to ball valve under the hand control panel.
3. Assembled PART 4 (PIPE TUBE) to PART 1 (BASE UNIT).
4. Joint PART 7 (PIPE TUBE) to PART 5 (SHOWER VALVE UNIT)
5. Assembled PART 5 (SHOWER VALVE UNIT) to PART 6 (SHOWER HEAD).
6. Connect PART 7 (PIPE TUBE) to PART 4 (PIPE TUBE).
7. Connect PART 1 (BASE UNIT) Waste Receptor to waste water outlet.
8. Secure entire unit on the floor for stability.
9. Connect Foot Panel chain to the Hand panel small hole.

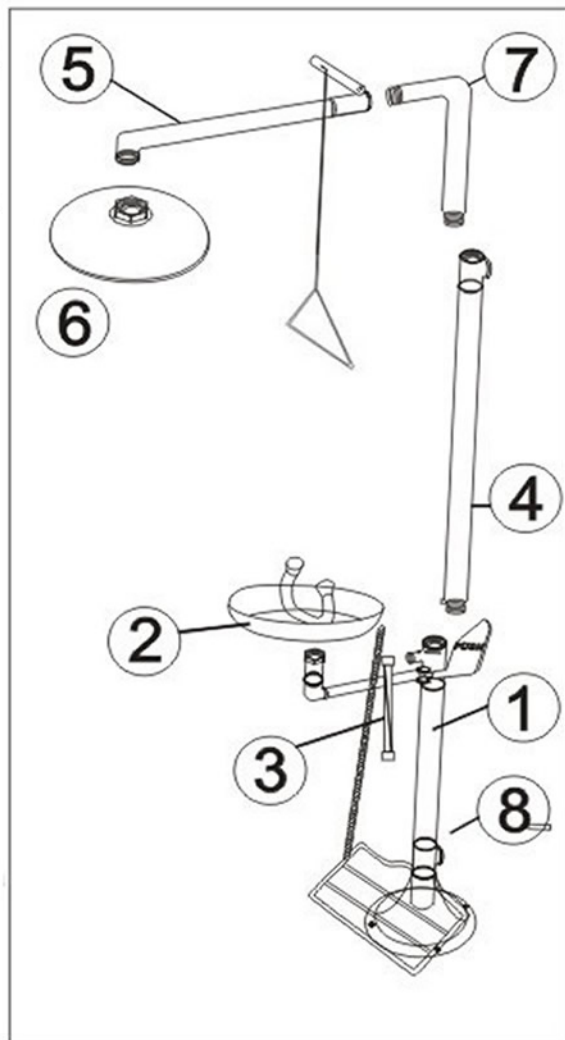

NOTES:

- A. All threads are tapered pipe and require pipe joint compound or Teflon tape to assure watertight connection.
- B. If unit is furnished with corrosion resistant epoxy coating, care must be taken to avoid damaging finish during assembly. For best result, a strap wrench should be used.
- C. Test the entire unit for proper operation.